

# WAŁKI ZĘBATE PASOWE O PODZIAŁCE CALOWEJ

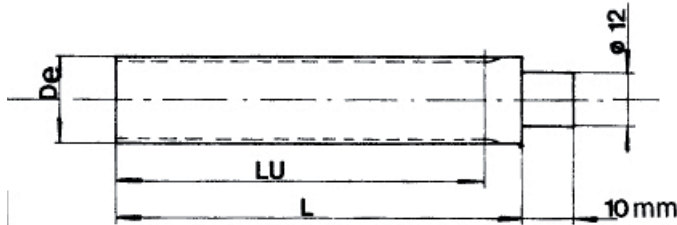

## MXL - 0.080" (mm 2,032)

RODZAJ	KOD		ILOŚĆ ZĘBÓW	De	LU	L
	AL.					
MXL10	WMXL010		10	5,97	50	75
MXL11	WMXL011		11	6,60	50	75
MXL12	WMXL012		12	7,26	50	75
MXL13	WMXL013		13	7,90	50	75
MXL14	WMXL014		14	8,56	50	75
MXL15	WMXL015		15	9,19	50	75
MXL16	WMXL016		16	9,83	50	75
MXL17	WMXL017		17	10,49	50	75
MXL18	WMXL018		18	11,12	50	75
MXL19	WMXL019		19	11,78	90	120
MXL20	WMXL020		20	12,42	90	120
MXL21	WMXL021		21	13,08	90	120
MXL22	WMXL022		22	13,72	125	140
MXL23	WMXL023		23	14,38	125	140
MXL24	WMXL024		24	15,01	125	140
MXL25	WMXL025		25	15,67	125	140
MXL26	WMXL026		26	16,31	125	140
MXL27	WMXL027		27	16,94	125	140
MXL28	WMXL028		28	16,70	125	140
MXL29	WMXL029		29	18,24	125	140
MXL30	WMXL030		30	18,90	125	140
MXL32	WMXL032		32	20,19	125	140
MXL34	WMXL034		34	21,49	125	140
MXL35	WMXL035		35	22,12	132	140
MXL36	WMXL036		36	22,78	132	140
MXL38	WMXL038		38	24,08	132	140
MXL40	WMXL040		40	25,37	132	140
MXL42	WMXL042		42	26,67	140	140
MXL44	WMXL044		44	27,94	140	140
MXL45	WMXL045		45	28,60	140	140
MXL48	WMXL048		48	30,53	140	140
MXL50	WMXL050		50	32,33	140	140
MXL60	WMXL060		60	38,30	160	160
MXL64	WMXL064		64	40,89	160	160
MXL65	WMXL065		65	41,53	160	160
MXL70	WMXL070		70	44,78	160	160
MXL72	WMXL072		72	46,05	160	160
MXL75	WMXL075		75	48,01	160	160
MXL90	WMXL090		90	57,71	160	160
MXL110	WMXL110		110	70,64	160	160

## XL - 1/5" (mm 5,08)

RODZAJ	KOD		ILOŚĆ ZĘBÓW	De	LU	L
	AL.	C40				
XL10	WXLA010	WXLC010	10	15,66	125	140
XL11	WXLA011	WXLC011	11	17,28	125	140
XL12	WXLA012	WXLC012	12	18,90	125	140
XL13	WXLA013	WXLC013	13	20,51	125	140
XL14	WXLA014	WXLC014	14	22,13	132	140
XL15	WXLA015	WXLC015	15	23,75	132	140
XL16	WXLA016	WXLC016	16	25,36	140	140
XL17	WXLA017	WXLC017	17	26,98	140	140
XL18	WXLA018	WXLC018	18	28,60	140	140
XL19	WXLA019	WXLC019	19	30,22	140	140
XL20	WXLA020	WXLC020	20	31,83	140	140
XL21	WXLA021	WXLC021	21	33,45	160	160
XL22	WXLA022	WXLC022	22	35,07	160	160
XL23	WXLA023	WXLC023	23	36,60	160	160
XL24	WXLA024	WXLC024	24	38,30	160	160
XL25	WXLA025	WXLC025	25	39,93	160	160
XL26	WXLA026	WXLC026	26	41,53	160	160
XL27	WXLA027	WXLC027	27	43,15	160	160
XL28	WXLA028	WXLC028	28	44,77	160	160
XL29	WXLA029	WXLC029	29	46,39	160	160
XL30	WXLA030	WXLC030	30	48,00	160	160
XL32	WXLA032	WXLC032	32	51,24	160	160
XL34	WXLA034	WXLC034	34	54,47	160	160
XL35	WXLA035	WXLC035	35	56,09	160	160
XL36	WXLA036	WXLC036	36	57,70	160	160
XL38	WXLA038	WXLC038	38	60,94	160	160
XL40	WXLA040	WXLC040	40	64,17	160	160
XL42	WXLA042	WXLC042	42	67,41	160	160
XL44	WXLA044	WXLC044	44	70,64	160	160
XL45	WXLA045	WXLC045	45	72,26	160	160
XL48	WXLA048	WXLC048	48	77,11	160	160
XL50	WXLA050	WXLC050	50	80,33	160	160
XL60	WXLA060	WXLC060	60	96,51	160	160
XL64	WXLA064	WXLC064	64	102,95	160	160
XL65	WXLA065	WXLC065	65	104,56	160	160
XL70	WXLA070	WXLC070	70	112,68	160	160
XL72	WXLA072	WXLC072	72	115,92	160	160

## L - 3/8" (mm 9,525) aluminium/stal

RODZAJ	KOD		ILOŚĆ ZĘBÓW	De	LU
	AL.	C40			
L10	WOLA010	WOLC010	10	29,56	140
L11	WOLA011	WOLC011	11	32,59	140
L12	WOLA012	WOLC012	12	35,62	160
L13	WOLA013	WOLC013	13	38,65	160
L14	WOLA014	WOLC014	14	41,68	160
L15	WOLA015	WOLC015	15	44,72	160
L16	WOLA016	WOLC016	16	47,75	160
L17	WOLA017	WOLC017	17	50,78	160
L18	WOLA018	WOLC018	18	53,81	160
L19	WOLA019	WOLC019	19	56,84	160
L20	WOLA020	WOLC020	20	59,88	160
L21	WOLA021	WOLC021	21	62,91	160
L22	WOLA022	WOLC022	22	65,94	160
L23	WOLA023	WOLC023	23	68,97	160
L24	WOLA024	WOLC024	24	72,00	160
L27	WOLA027	WOLC027	27	81,10	160
L30	WOLA030	WOLC030	30	90,20	160

